

MAGLOCLLEN Provides Action Response Plans for Schools

By Steve Tori, MAGLOCLLEN Senior Supervisory Intelligence Analyst

Active shooter incidents across America are at an all-time high. In 2017, there were 30 separate active shootings in the United States, the largest number ever recorded during a one-year period (FBI, Pre-Attack Behaviors of Active Shooters, June 2018). Even more alarming is the fact that many of these premeditated attacks target our most vulnerable population—children attending school. Regardless of an individual’s motive, troubling warning signs, or tactics, American law enforcement personnel must prepare and train for these tragic events and react to them at a moment’s notice.

With this preplanning in mind, MAGLOCLLEN has been providing School Action Response Plans (ARPs) since 2006 to provide state and local agencies with situational awareness of critical information related to schools within its jurisdiction. In December 2012, following the events in Newtown, Connecticut, MAGLOCLLEN began to proactively promote this valuable service to law enforcement. Since January 2013, MAGLOCLLEN has completed ARPs for 647 individual school buildings throughout the Mid-Atlantic region.

Current law enforcement training and tactics have dictated that the initial responding officers are the ones charged with entering and mitigating the threat of an active shooter scene. Long gone are the days when first-arriving officers simply secured the perimeter and waited for the Special Weapons and Tactics (SWAT) team. There is simply no time to wait for an emergency response team or specialized tactical unit. The ARPs contain the critical data, photographs, and floor plans necessary for patrol officers to effectively navigate a chaotic scene.

School ARPs are composed of three primary components: **aerial imagery, ground-level perimeter photographs, and detailed floor plans.** This package is not intended to usurp a comprehensive tactical response strategy to a specific school building. Rather, it is designed to provide first-in officers with the situational awareness of crucial information, locations, and layouts that they need to help mitigate an imminent threat. When used in conjunction with routine school visits, tabletop exercises, and on-site tactical training, an officer’s prior familiarization with these plans will benefit him or her in the event of an emergency response.

The specific content contained within each ARP is at the sole discretion of the requesting law enforcement agency. MAGLOCLLEN analysts will provide general guidance to requesting agencies and advice on common best practices, but the amount of detail and descriptive data is up to the agency.

General notations on all three components of the ARP might include the:

- Name and address of the school
- Emergency contact information for the school facility, including after-hours contacts; name and cell phone numbers of the Principal, the head custodian, etc.; and the main phone number for the school
- Key times of the day (student arrival/departure, start/end of school day, lunch periods, etc.)

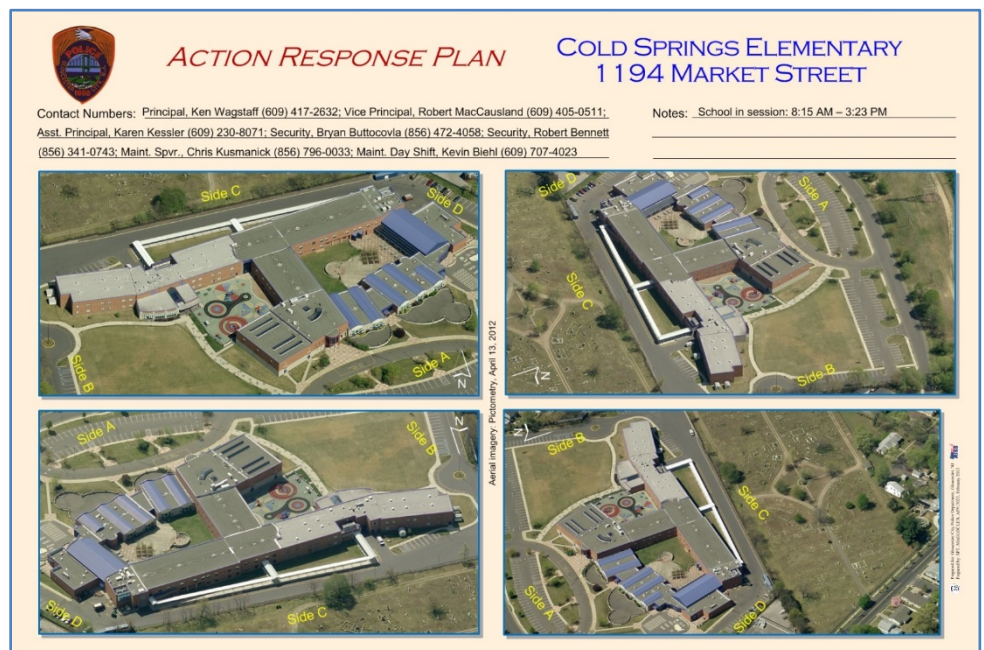

- Secure WiFi log-in information so that officers can access the school's camera system from their mobile data terminals (MDTs) while still outside the building

Aerial Imagery

The first component of an ARP is high-resolution, low-altitude aerial imagery. MAGLOCLen currently contracts with a nationwide vendor to obtain the imagery of a specific school building. MAGLOCLen's contract provides for online access to a vast database of oblique aerial imagery. Each ARP contains 4 oblique images that are captured at an angle of 40 to 45 degrees. These low-altitude images (approximately 1,200 feet) are designed to provide a more natural perspective and make objects easier to recognize and interpret. Oblique aerial images captured from the north, south, east, and west directions offer a 360-degree view of every school building (<https://www.eagleview.com/product/pictometry-imagery/>).

The included images, coupled with agency-designated annotations, provide a virtual 360-degree size-up. Through prior review of these plans, officers will already know critical details, such as where the exterior door locations are, what objects provide sufficient cover, and which side of the building is considered Side A versus Side C.

Exterior Photographs

The second component of an ARP is exterior ground-level photographs taken of the entire perimeter of the school building.

These digital images are obtained by the requesting agency and provided to MAGLOCLen via an email or a CD. Most ARPs contain approximately 24 individual photographs and include any relevant captions, as needed. Exterior doors are often sequentially numbered and the locations of utilities are also noted.

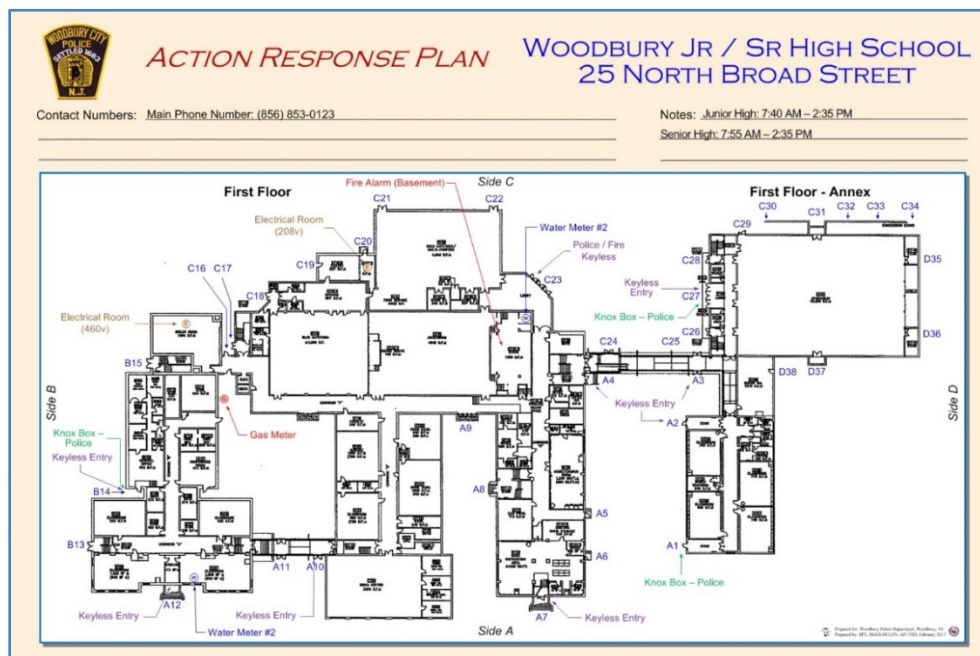

Floor Plans

The final, and often most detailed component of the ARP, is the floor plan. Agencies provide MAGLOCLen with a general floor plan for each level (floor) of the school building. Ideally, the floor plan should be clean, with minimal extraneous text, and have the rooms labeled accordingly. Generic floor plans, similar to those provided to students and faculty, often work best.

Annotations to include on the floor plans may include:

- Knox Box and burglar/fire alarm panel locations
- Administrative offices
- Labeling of security camera locations and corresponding fields of view
- Security office where cameras can be viewed
- Roof hatches (are they padlocked from the inside or outside?)
- Utility shutoffs (gas, electric, water, phones, cable, etc.)
- Stairwells, elevators, automated external defibrillators, etc.
- National Incident Management System-compliant labeling of building sides on aerial imagery and floor plans (i.e., Side A, B, C, D)
- Identification of which doors operate electronically (key fobs, card readers, etc.) versus manually
- Safe-harbor locations inside the school for students/staff
- Exterior rally points for students/staff following evacuation

Upon completion of the ARP, MAGLOCLLEN will create both digital and hard copy versions. The hard copy charts are 24” high x 36” wide and are printed on high-gloss photo paper and laminated. These charts are particularly useful in tabletop exercises and preplanning. The digital files (as JPEGs or PDFs) can then be shared with officers throughout the agency for use in their MDTs, agency computers, and smartphones. Furthermore, agencies are strongly encouraged to share the digital images with their regional emergency management entity, as well as with their mutual aid departments. Any response to an active shooter or other school emergency will most likely result in a far-reaching, multijurisdictional response. Officers in neighboring towns will benefit from a prior understanding of the ARP and the situational awareness that it provides.

The feedback MAGLOCLLEN has received from agencies that have secured these plans has been overwhelmingly positive as indicated below.

“The response plans developed by MAGLOCLLEN for the Schenectady Police Department are an invaluable resource, both for training and for an emergency response to a campus incident. The plans provide us important information to respond expeditiously and effectively to any of the schools for which an action plan has been developed. The plans, containing aerial photos of our campuses, exterior photos, floor plans, diagrams, and other critical school district information, could not have been produced had it not been for MAGLOCLLEN. With the Action Response Plans, we have enhanced the level of safety and security for nearly 4,000 students, faculty, and staff in our schools.”

**—Chief Brian Kilcullen
Schenectady, New York, Police Department**

School Action Response Plans “serve as the cornerstone of Abington’s program to protect our children and school staff.”

**—Dr. Amy Sichel
Abington, Pennsylvania, School District Superintendent**

Questions regarding ARPs can be directed to Steve Tori, Senior Supervisory Intelligence Analyst, MAGLOCLLEN, 140 Terry Drive, Suite 100, Newtown, PA 18940, (800) 345-1322, extension 1551, or by email at stori@magloclen.riss.net.